

# Product data sheet

## Zipar Duo Recessed

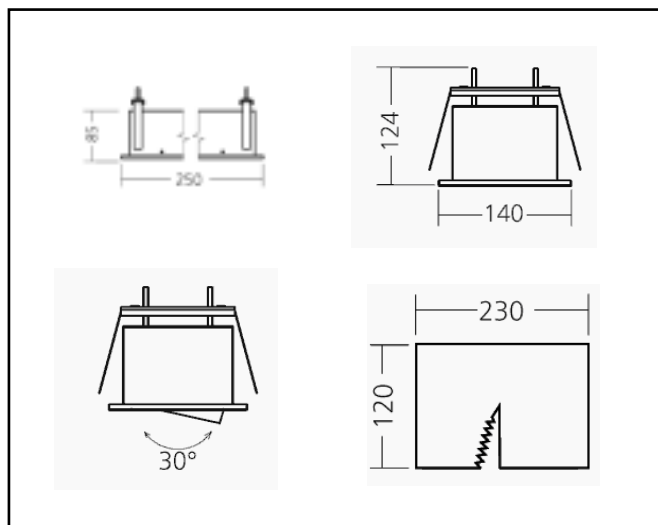

<b>Description</b>	Recessed, accent spot
<b>Dimensions (mm)</b>	250mm x 140mm x124mm
<b>Weight (kg)</b>	1,500 kg
<b>Housing</b>	Sheet steel – extruded aluminium
<b>Colour</b>	White, black, grey
<b>Optical system</b>	Facetted reflector
<b>Lighting Distribution</b>	Direct, 24° rotational symmetric
<b>Unified Glare Ratio</b>	<19
<b>Colour temperature (K)</b>	3000 K
<b>CRI (Ra)</b>	> 80
<b>SCDM</b>	3
<b>Net lumen output (25°C)</b>	2900 lm
<b>Efficacy – LOR (lm/W)</b>	132lm/W
<b>Power (driver incl.)</b>	22 W
<b>Driver</b>	Separate box included, Dali dimmable
<b>IP</b>	IP 20
<b>IK</b>	IK 02
<b>Lifetime (hours)</b>	50.000 hours L80 B10
<b>Warranty</b>	5 years
<b>Origin</b>	Slovakia
<b>Norms</b>	LVD 2006/95/EC EMC 2004/108/EC RoHS 2001/65/EC

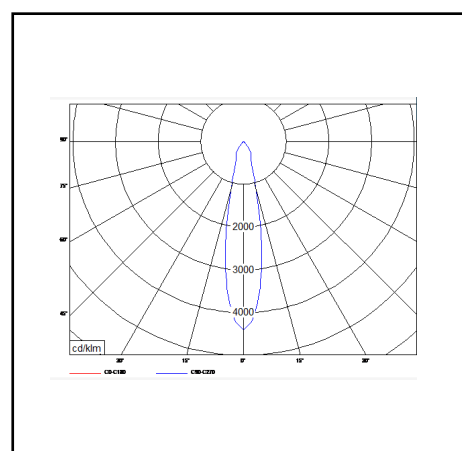
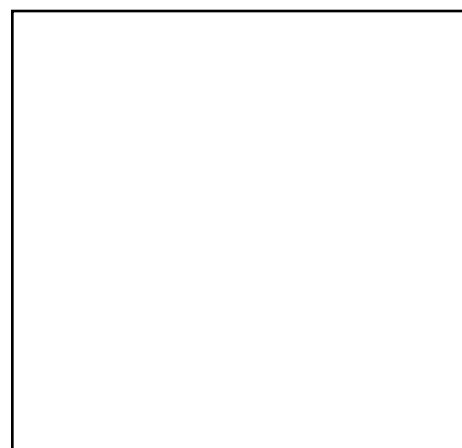

All specifications, descriptions and images are purely informative, not binding and subject to errors and changes

Euro-Luce Light Engineering  
Ballingsweg 25 – 9620  
Zottegem  
[info@euro-luce.be](mailto:info@euro-luce.be)  
[www.euro-luce.be](http://www.euro-luce.be)  
Tel 0032 54 55 71 10